

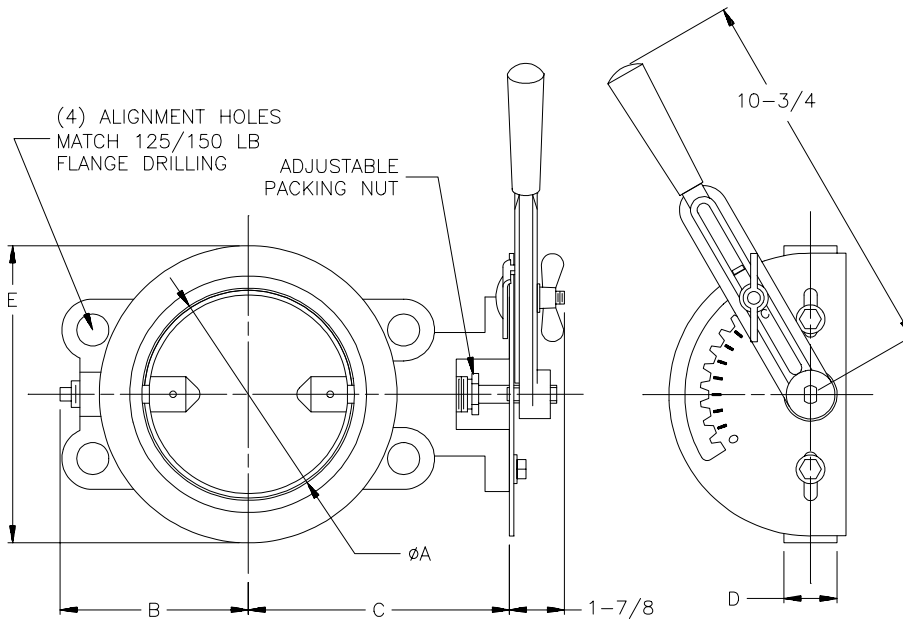

**NATIONALTURBINE CORPORATION**  
 374 Northern Lights Drive  
 Syracuse, NY 13212  
 888-293-7434 fax 315-455-5545  
 www.nationalturbine.com  
 sales@nationalturbine.com

## ACCESSORIES

### BUTTERFLY VALVES WAFER STYLE, LEVER ACTUATOR



Assembly Part Number	Size (A)	B	C	D	E	Approx. Weight
BFC-300	3.0	3.13	7.88	1.5	5.13	12.0
BFC-500	5.0	4.88	8.88	1.5	7.5	16.0
BFC-600	6.0	5.38	9.38	1.5	8.5	18.0
BFC-800	8.0	6.5	10.38	1.5	10.75	24.0
BFC-1000	10.0	8.0	12.63	1.88	13.0	42.0
BFC-1200	12.0	9.5	13.63	1.88	15.25	52.0

#### MATERIALS OF CONSTRUCTION

BODY	CAST IRON CL. 30
DISC	CAST IRON CL. 30
SHAFT	416 STAINLESS STEEL
BUSHING	GRAPHITED BRONZE
PACKING	GRAPHITED TEFLON BRAID
PACKING NUT	BRASS
SEAT	SWING-THRU

#### RATING

TEMPERATURE	450° F
-------------	--------

DIMENSIONS SUBJECT TO CHANGE WITHOUT NOTICE  
 COPYRIGHT 1999-2002 NATIONAL TURBINE CORPORATION