



NATIONALTURBINE CORPORATION
 374 Northern Lights Drive
 Syracuse, NY 13212
 888-293-7434 fax 315-455-5545
 www.nationalturbine.com
 sales@nationalturbine.com

CENTURION SERIES TECHNICAL DATA AND DIMENSIONS

NT225 MULTISTAGE CENTRIFUGAL BLOWERS & EXHAUSTERS



GENERAL PERFORMANCE CURVES
 3-5 STAGE BELT DRIVE 8180 RPM

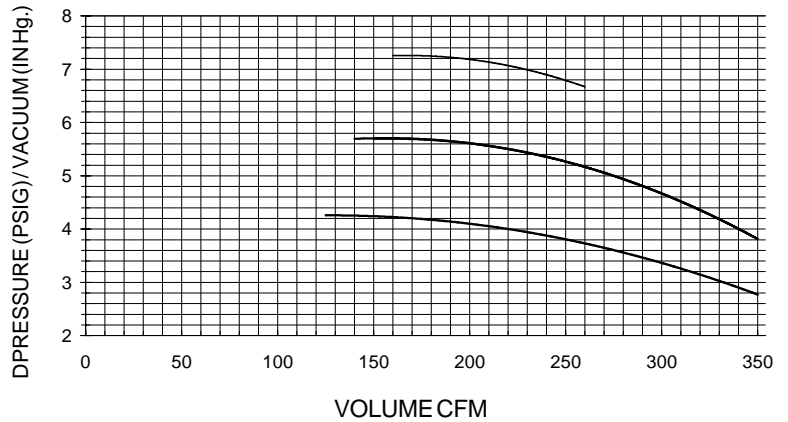

Technical Specifications

- Number of Stages 1 through 5
- Inlet Connection 2 7/8 Pipe, (optional) 2 1/2 NPT or 3" (76.2 mm) Flange, ASA 125# Drilling
- Outlet Connection 2 7/8 Pipe, (optional) 2 1/2 NPT or 3" (76.2 mm) Flange, ASA 125# Drilling
- Operating Speed 3550, 7050 or 8180 RPM
- Maximum Casing Pressure 15 PSIG (1.05 kg/cm²)
- Seals (air) Labyrinth
- Bearings Ball, 10-Year Minimum Life Per AFBMA B-10 Standard (Made in U.S.A.)
- Lubrication Grease
- Impeller Diameter 11" (279.4 mm)
- Impeller Tip Speed 23557 FPM at 8180 RPM
- Drive Type Belt drive or direct coupled
- Max. Vibration Spec. 0.48 in/sec (ISO overall spec.), 3.0 mils peak to peak
- Shaft End 7/8" (22.3 mm) Diameter, Inlet Drive Standard
- Noise Level Compliant With OSHA Standards (Certified test available)

Materials of Construction

- Casing Cast Aluminum 319 alloy
- BearingHousings Cast aluminum alloy ZA-12
- Bearing Caps Cast Aluminum 319 alloy
- Shaft Carbon Steel AISI 4140 (stainless steel available)
- Impellers Cast Aluminum 319 alloy
- Labyrinth Seal Integral to inlet and outlet heads
- Tie Rods Galvanized Steel
- Base Structural Steel
- Motor Pedestal Welded steel plate
- Base Pads Neoprene rubber
- Finish Industrial Enamel



**100% Made in the
 U.S.A.**



NATIONALTURBINE CORPORATION
 374 Northern Lights Drive
 Syracuse, NY 13212
 888-293-7434 fax 315-455-5545
 www.nationalturbine.com
 sales@nationalturbine.com

CENTURION SERIES TECHNICAL DATA AND DIMENSIONS

NT 225 Series

GENERAL DIMENSIONS (All dimensions in inches)

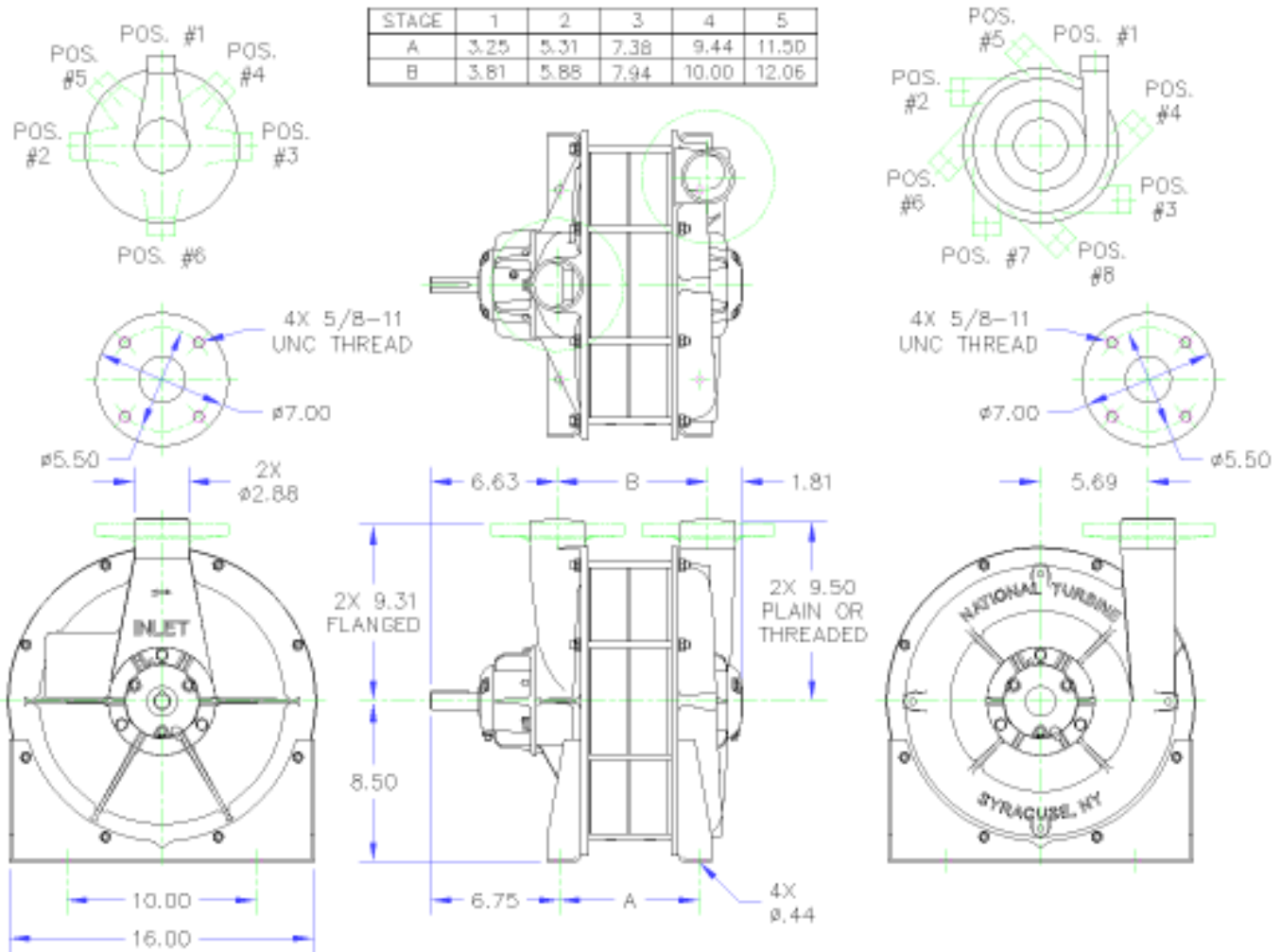

Both the inlet and outlet can be provided in different positions